



WAS \$1,196,000

NOW
\$1,146,000*



ASPIRE.
MORE
FOR LESS

UP TO
\$65k
OF VALUE



LEARN MORE

ASPIRE RANGE FOR A LIMITED TIME ONLY

HOME SIZE **171.2m²** | LAND SIZE **301m²**

House and Land Package

Lot 1007 Alma Place, Oakville, Alma Place, Oakville

UPGRADES INCLUDED

→ Aspire Inclusions

- Blinds to the home
- Coloured Render to Trims of Façade
- Ducted Air
- 20mm Stone Benchtops to Kitchen
- 900mm wide Smeg Appliances
- Smeg Freestanding Dishwasher
- Smeg Microwave
- Floor Coverings throughout
- Remote Control for garage
- Soft close drawers to kitchen
- 2450mm Ceiling Heights
- Hybrid Framing
- Current Promotion Included
- Fixed Site Cost
- Driveways, Landscaping and Fencing
- Smart Solar System

Thomas Williamson | TWilliamson@cpgestates.com.au |

*Terms and conditions apply: Images are provided for illustrative purposes only. Additional charges may apply where designs or facades are modified and/or floorplan options added. Land value included in the package. Clarendon Homes reserves the right to change the price without notice. Only applies to home built in NSW. E&OE. Clarendon Homes (NSW) Pty Ltd. ABN 18 003 892 706 BL 22 98 C.

ELLIS 18 CARLTON FACADE

Lot 1007 Alma Place, Oakville, Alma Place, Oakville

Clarendon
Homes

HOME SIZE 171.2m² | LAND SIZE 301m²

4  | 1  | 2  | 1 

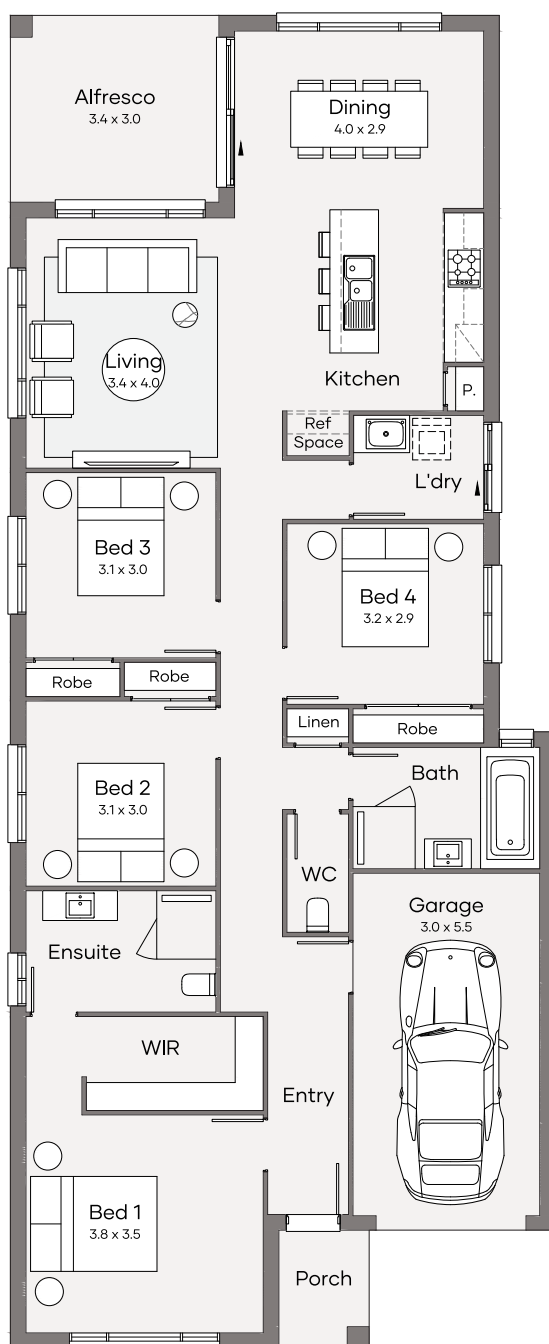

Note: Please speak to a Sales Consultant to see this house design sited on the block.

Thomas Williamson | TWilliamson@cpgestates.com.au |

*Terms and conditions apply: Images are provided for illustrative purposes only. Additional charges may apply where designs or facades are modified and/or floorplan options added. Land value included in the package. Clarendon Homes reserves the right to change the price without notice. Only applies to home built in NSW. E&OE. Clarendon Homes (NSW) Pty Ltd. ABN 18 003 892 706 BL 22 98 C.

ABN 18 003 892 706 BL 22 98 C. Date/Time: 14/7/2025 08:39